

**General hints:**

**A. Surfacing requirements**

This equipment should be installed on an impact absorbing surfacing / loose fill material that accords with EN 1177 and is adequate for a maximum free height of fall of 1.80 m. At least 40 cm of play sand are required for the correct functioning of the equipment.

**B. Foundations**

Please see detailed instructions at the end of this document, especially depths of foundations for steel feet.

**Special information:**

Tested by TÜV Product Service GmbH.

Please do not alter any parts of the equipment or the construction itself since this may affect the safety standards and your guarantee.

We reserve the right to make technical alterations!  
For further information please call your local agent.

**Foundation blocks:**

Platform	4 pieces 60 x 60 x 40 cm Excavation depth 70 cm, with steel feet 80 cm
Sand tipper	1 piece 60 x 135 x 40 cm Excavation depth 70 cm
Net	1 piece 60 x 60 x 50 cm Excavation depth 70 cm
Sliding Pole	1 piece 40 x 40 x 30 cm Excavation depth 50 cm
Swing	2 pieces 60 x 70 x 60 cm Excavation depth 80 cm
Slide	1 piece 15 x 70 x 55 cm Excavation depth 55 cm

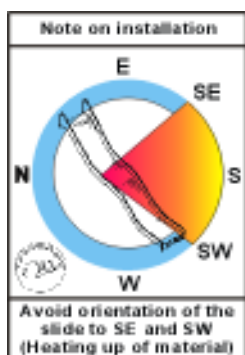

Please pay particular attention to the assembly instructions with order nos. 3.63020, 3.69350, 5.01200 and 6.13040

**Building Site Combination**

Order no. 5.03000

- with steel feet

Order no. L5.03000

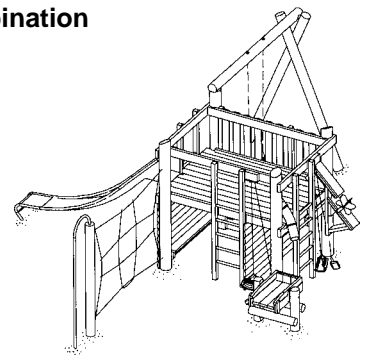

**Data for shipment:**

Number of parts: 21

- 1 front side, already attached  
1 ladder, 1 wall with bench
- 1 front side, already attached  
1 ladder, 1 sand hoist
- 2 floor panels
- 1 bundle: 2 tie beams for floor, 1 tie beam for handrail with sand hoist, 1 floor beam
- 1 bundle: 1 ladder, 2 shovels with chains
- 1 bundle: 2 beams for hut
- 2 walls for hut (one with bench, one with table)
- 1 sand chute with sand wheel
- 1 sand pipe, curved
- 1 bag of bolts
- 1 barrier
- 1 bundle: Stand posts for Swing
- 1 cross beam for Swing
- 1 bundle: Swing seat with chains
- 1 bundle: 1 beam, 1 net made of Corocord®-rope  
1 curved Sliding Pole  
2 distance battens
- 1 sand tipper
- 1 support frame for sand tipper
- 1 stainless steel slide, height 1.50 m
- 1 ground anchor with bolts

Total weight: 1200 kg  
Largest single part: 150 kg  
3.25 x 2.00 x 0.25 m

**Recommended assembly aids:**

- Set of carpenter's tools
- Set of ratchets
- Set of spanners
- Torx insert T 20, 25, 30, 40, 50
- Rubber mallet
- 4 screw clamps
- Battens for support during assembly

**Attention!**

During the assembly period (including the setting of the concrete) it is not allowed to play on or put any weight on the equipment in order to secure stability during use after the assembly. Standard concrete requires at least 2 weeks to set.

**Required space including safety distances (EN 1176):**

960 x 950 cm

**Ground elevation**

Scale 1:100

all dimensions in cm

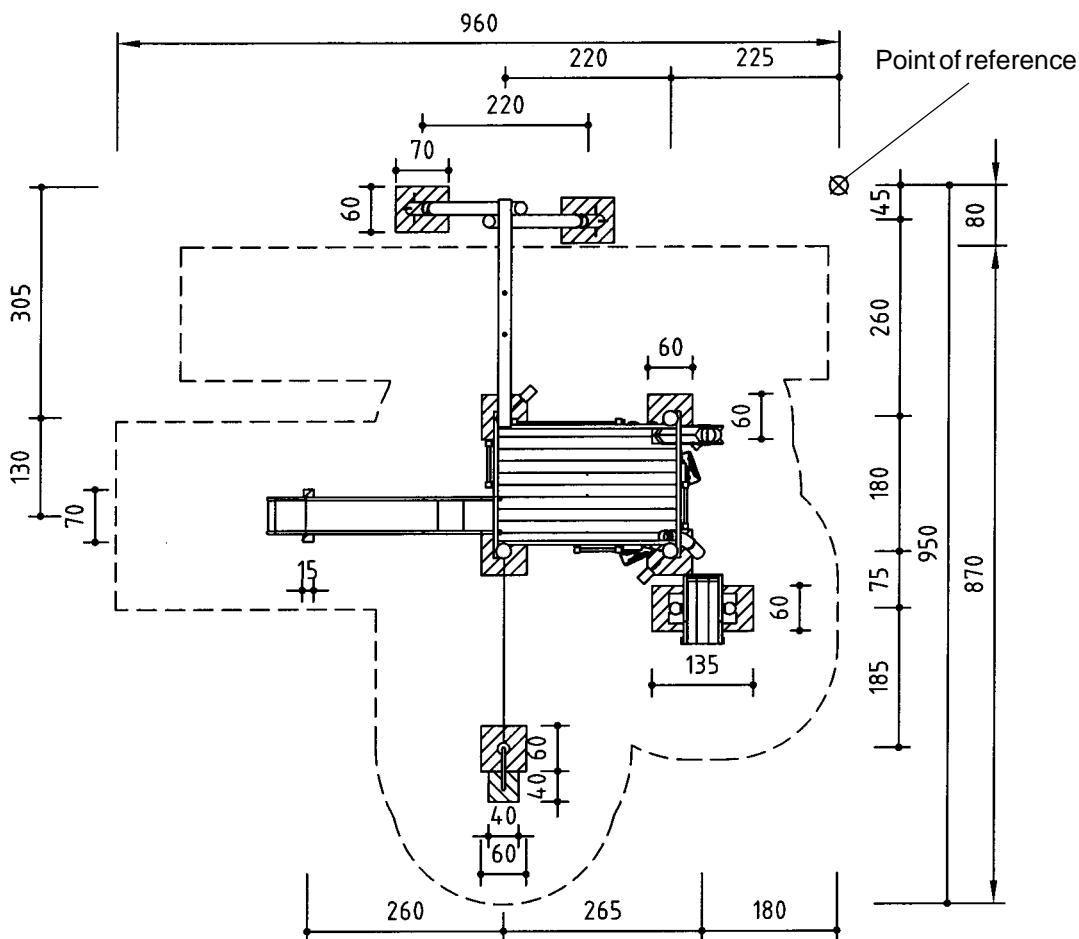

**Sequence of assembly operations:**

**General note:**

This playground equipment has been assembled completely in our workshop. All components are marked at their joints. Adhere strictly to these marks during assembly!

The Building Site is playground equipment for playing with sand. We recommend to assemble and erect the equipment prior to delivery of the sand. Then only the foundation holes for the stand posts must be dug out.

1. Locate the site and take into account the space required, including the safety distances, according to the ground elevation on page 1.
2. Start surveying at the point of reference  and dig out the foundation holes.

3. Place the pre-fabricated front sides next to the foundation holes and hammer the foundation irons into the stand posts.

4. Remove the top cladding board from the front side with wall.

5. Erect the front sides and support in position using battens. Insert the floor panels and secure in position using screw clamps. Please pay attention to the location of the hole for the sand pipe. Roughly align the equipment.

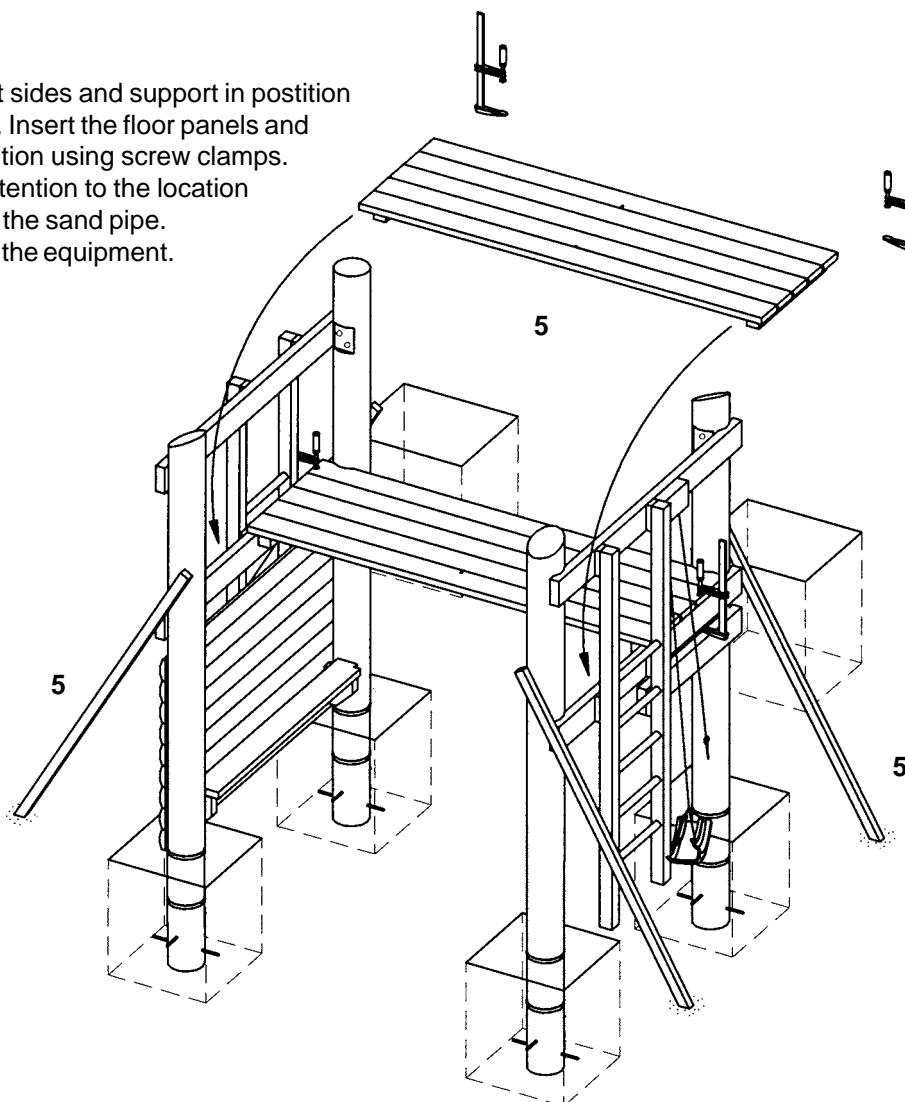
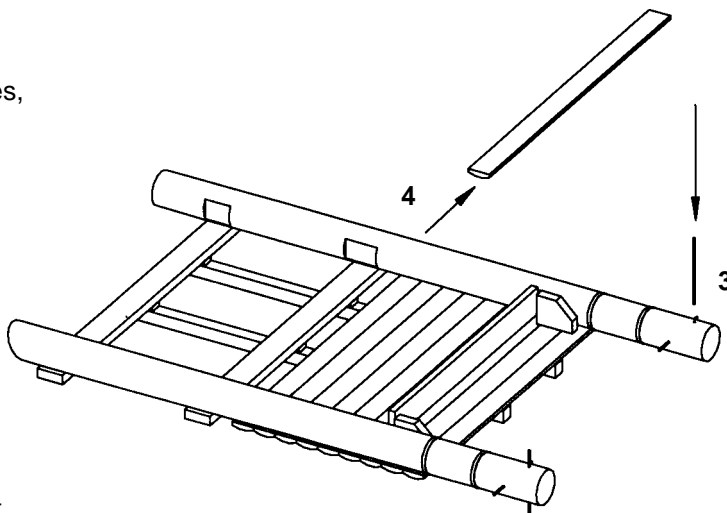

6. Screw the tie beams for floor and handrail (with the attached sand hoist) to the stand posts at the marked spots. Install the eyelet bolts for the sand hoists at the marked spots on the stand posts.

7. Install the barrier at the side facing the Swing.

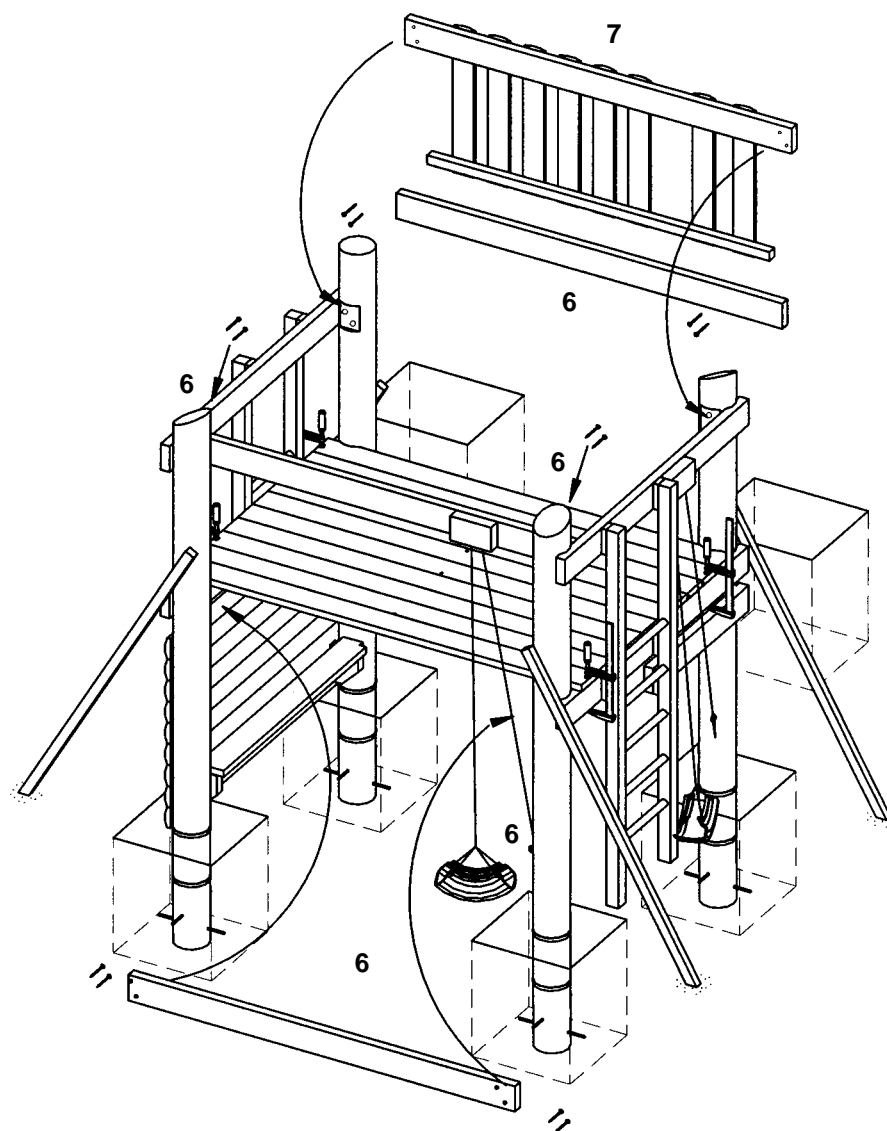

8. Screw the table onto the back wall at the marked spots.

9. Screw the two beams for the hut vertically onto the tie beams. Then screw the back wall from the inside onto the two beams.

10. Attach the floor beam to the bottom of the floor panels. Screw the floor panels to the front sides. Remove the screw clamps.

11. Install the ladders at the tie beams.

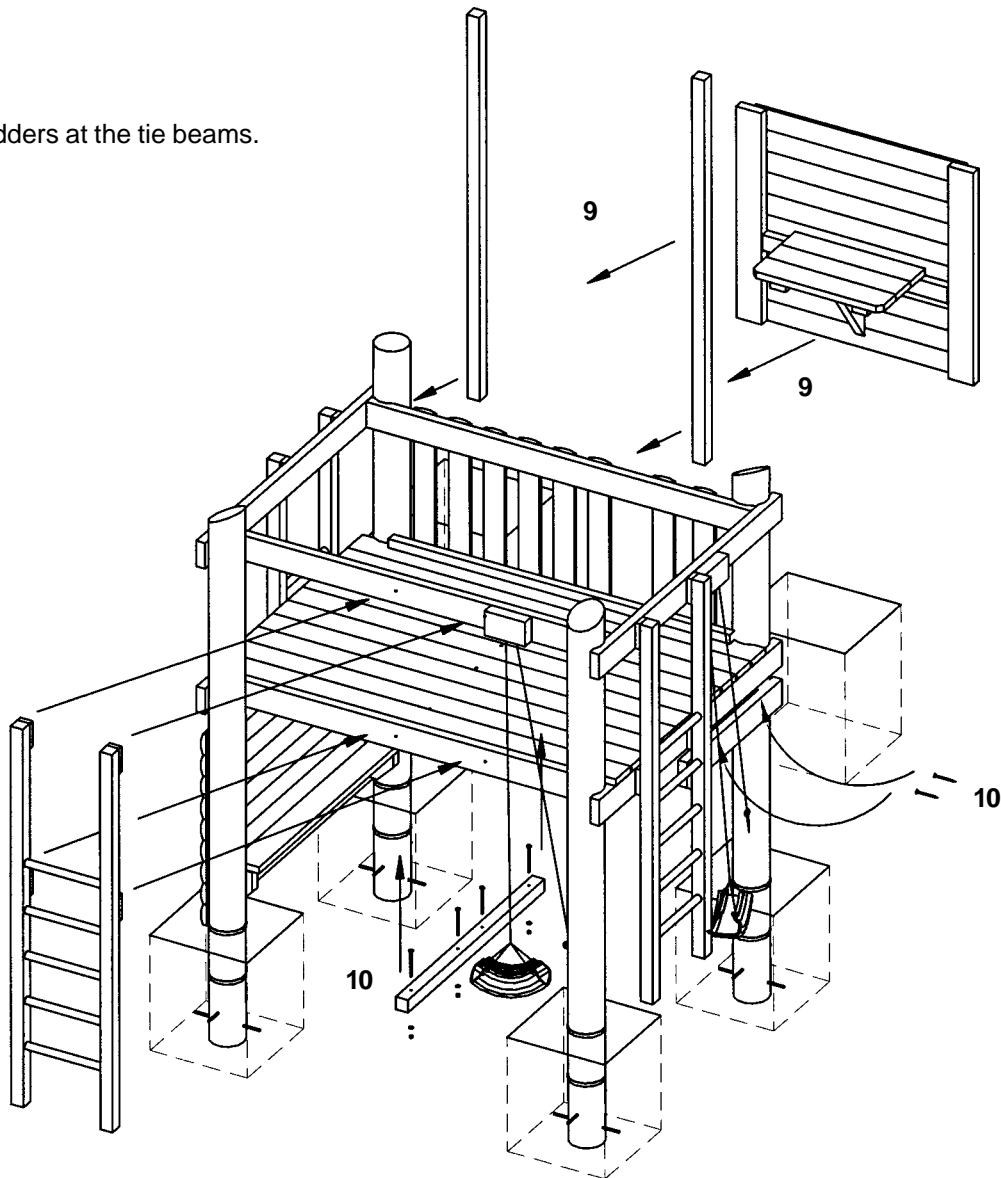
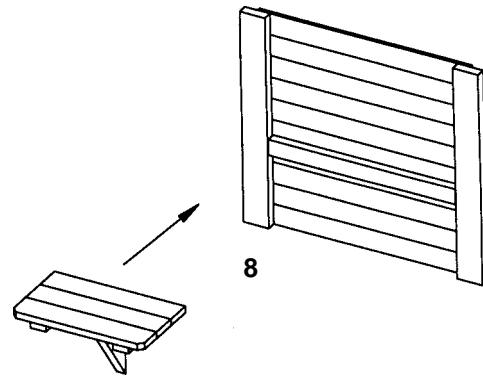

12. Install the cladding (removed under point 4).

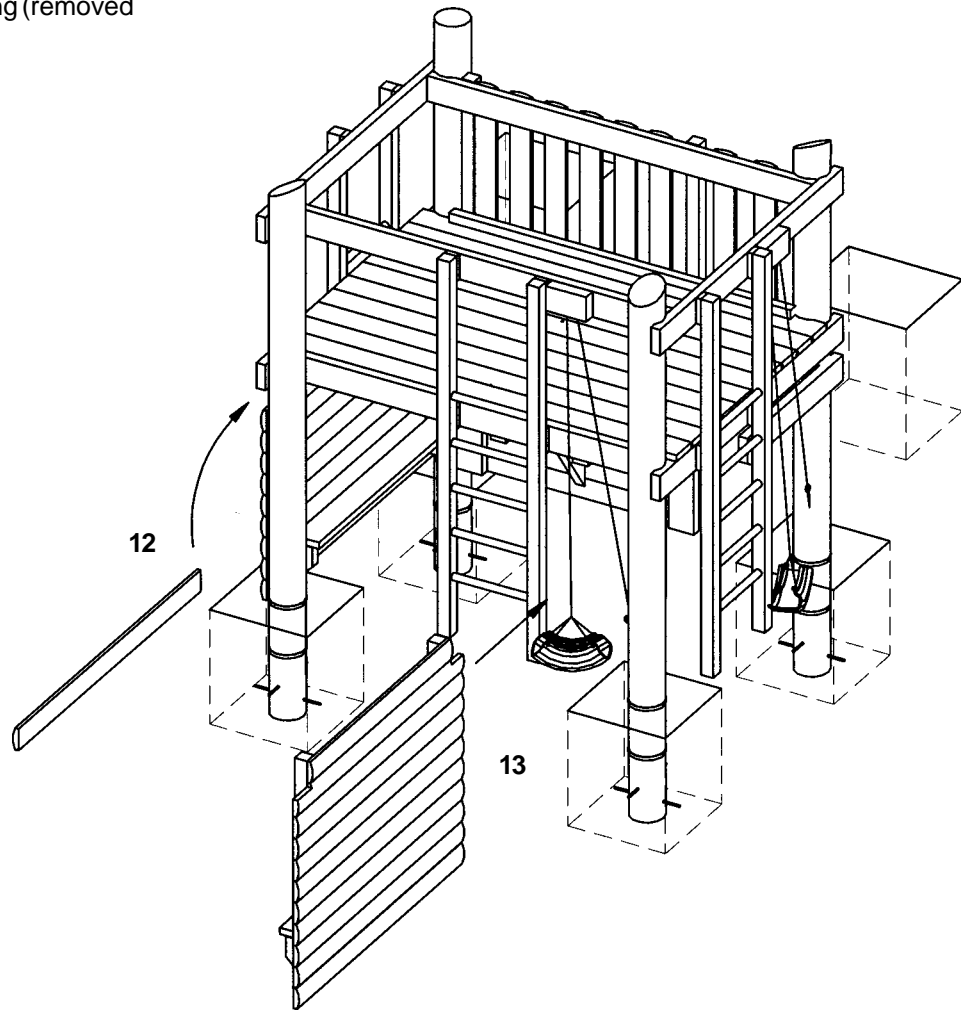

13. Insert the last remaining side wall of the hut between the vertical beam at the barrier and the opposite ladder and screw on.

14. Screw the sand chute with sand wheel according to the marks onto the tie beam and from below onto the floor panel. Install the eyelet bolt for the sand hoist at the sand chute, the position is marked.

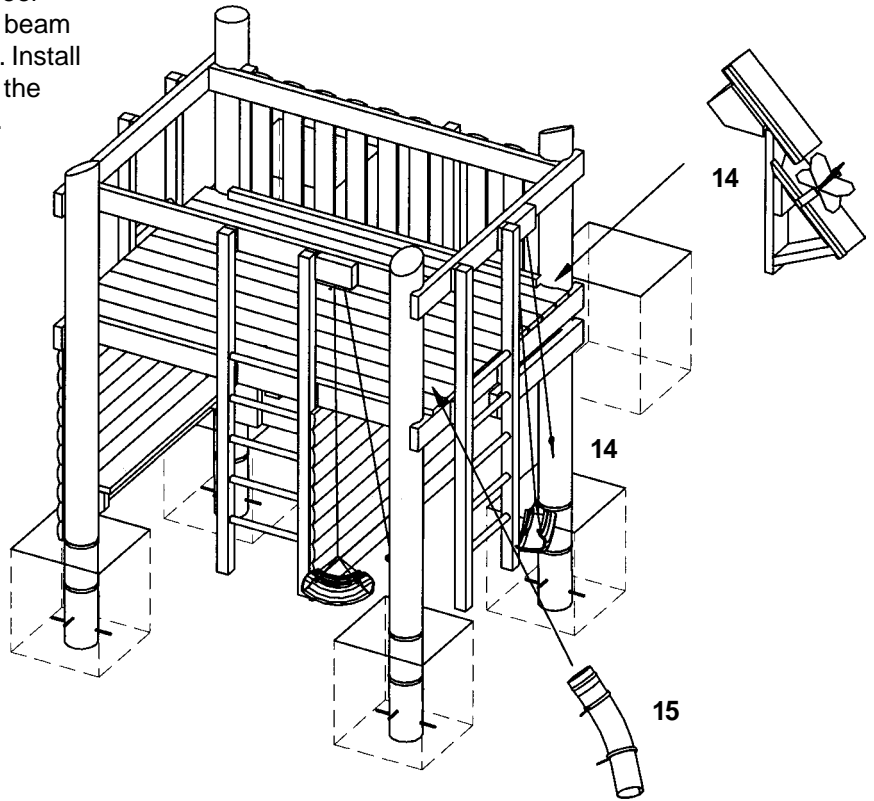

15. Attach the curved sand pipe with pipe clips to the plates of the stand post and the tie beam.

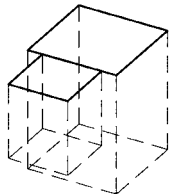
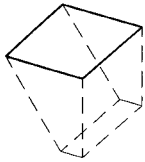

16. Install the attached equipments according to their assembly instructions.

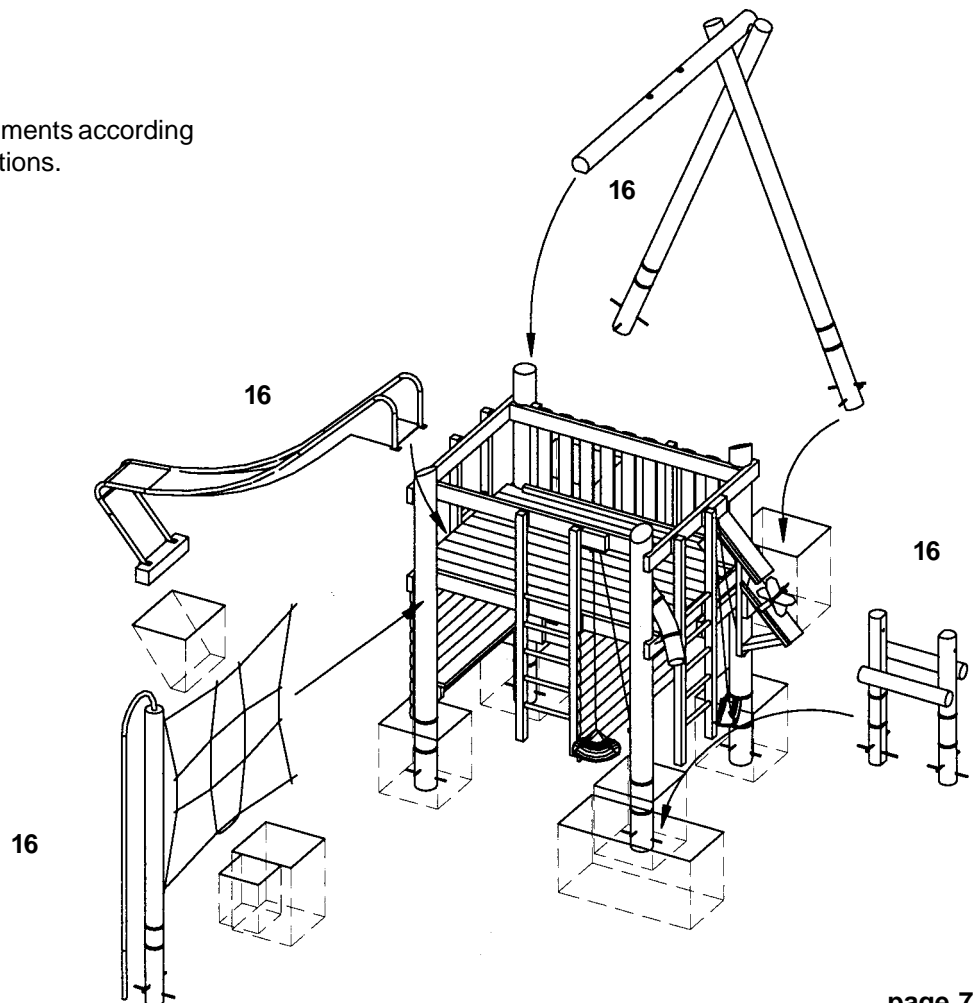

17. Screw one shovel each onto the stand posts (according to the marks).

18. Exactly align the equipment (spirit level, check the diagonal distances).  
Fill the foundation holes with concrete B 25 (earth damp), largest grain size 16 mm and tamp. Round the edges of the foundations and cover with ground material.

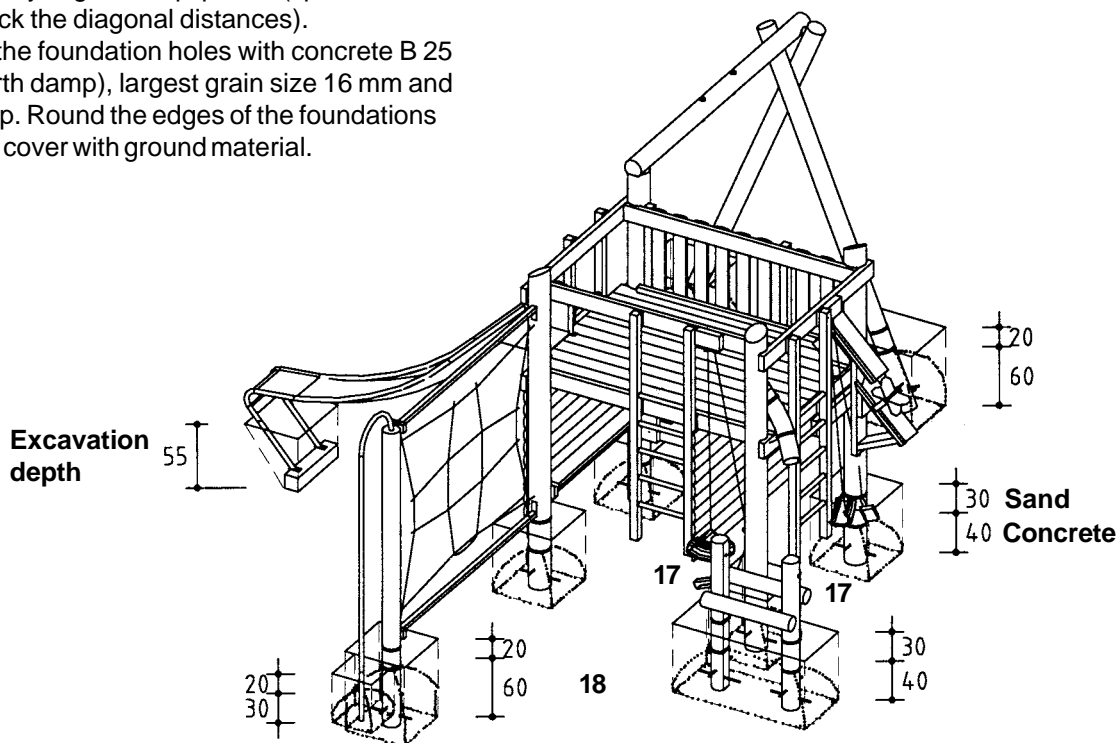

19. Repair minor damages caused during assembly or transportation.

20. Please ensure that all assembly aids, e. g. excess bolts, assembly instructions, distance battens or tape are removed entirely from the playground equipment and the playground after work is finished.

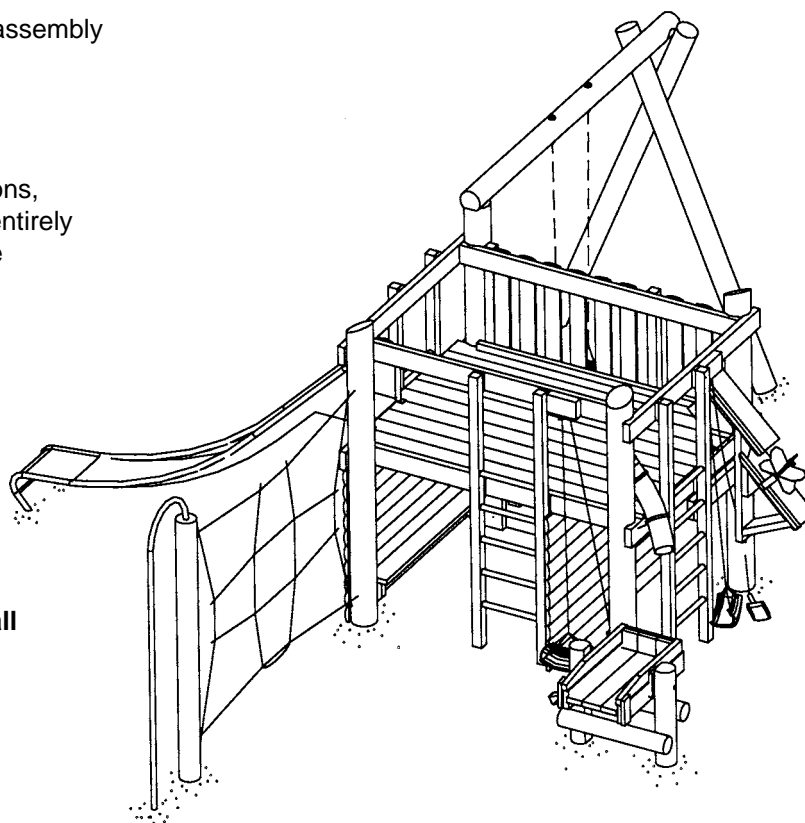

**Please note that after about 6 weeks all screws and bolts need to be checked and, if necessary, retightened.**