

General hints:

A. Surfacing requirements

The equipment must be installed in play sand to achieve its function.
 This equipment does not reach the free height of fall limit of 600 mm above which a specific requirement for impact absorbing surfacing or materials is necessary.

B. Foundations

Please see detailed instructions at the end of this document, especially depths of foundations for steel feet.

Special information:

Tested by TÜV Product Service GmbH.

Please do not alter any parts of the equipment or the construction itself since this may affect the safety standards and your guarantee.

We reserve the right to make technical alterations!
 For further information please call your local agent.

**Small Building Site
 Order no. 5.09300**

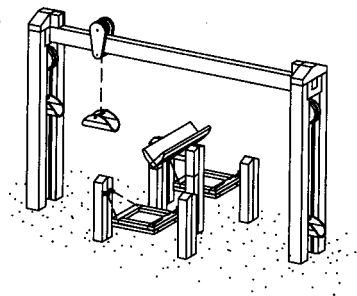

Data for shipment:

Number of parts: 6

- 2 support frames with sand hoist and shovels
- 1 transport rail
- 1 roller
- 1 bundle: sand-sieve, stand posts, distance batten
- 1 bundle: sand-see-saw, stand posts, distance batte

Total weight: 300 kg
 Largest single part: 100 kg
 0.10/0.16 x 3.10 m

En-EN 19.02.2004

Copyright © Richter Spielgeräte GmbH * 83112 Frasdorf * Germany

Required space including safety distances (EN 1176):

470 x 610 cm

Ground elevation
 no scale
 all dimensions in cm

Foundation blocks
 4 pieces 50 x 40 x 50 cm
 Excavation depth 70 cm
 2 pieces 80 x 60 x 50 cm
 Excavation depth 70 cm

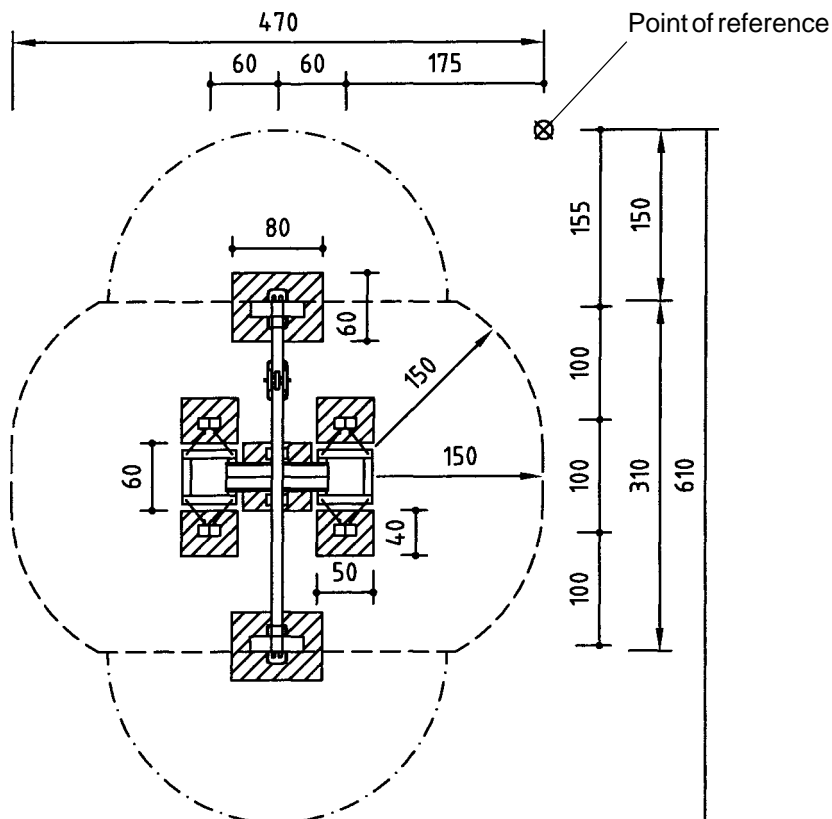

Recommended assembly aids:

- Set of carpenter's tools
- Set of ratchets
- Torx inserts T 20, 25, 30, 40, 50
- Battens for support during assembly
- Rubber mallet

Attention!

During the assembly period (including the setting of the concrete) it is not allowed to play on or put any weight on the equipment in order to secure stability during use after the assembly. Standard concrete requires at least 2 weeks to set.

Sequence of assembly operations:

1. Locate the site and take into account the space required, including the safety distances, according to the ground elevation on page 1.

2. Start surveying at the point of reference  and dig out the foundation holes.

3. Place the support frames in front of the foundation holes and hammer in the foundation irons.

4. Push the roller onto the transport rail and screw onto the stand posts as shown in **detail A** opposite.

5. Place the equipment into the foundation holes, align and support in position using support battens.

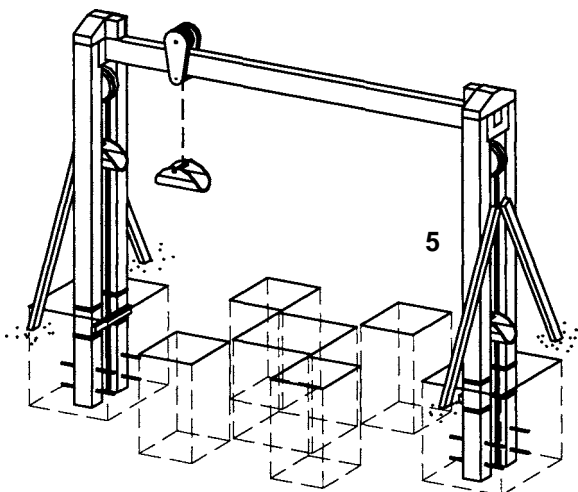
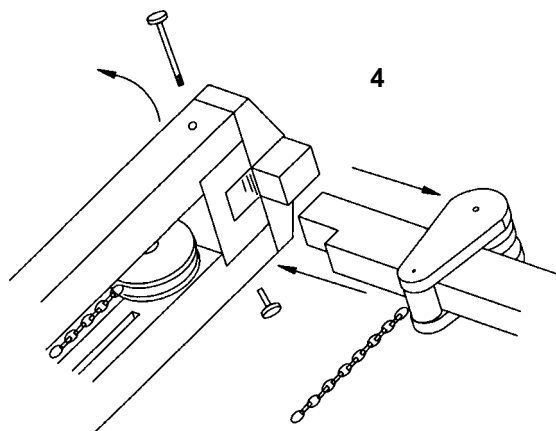
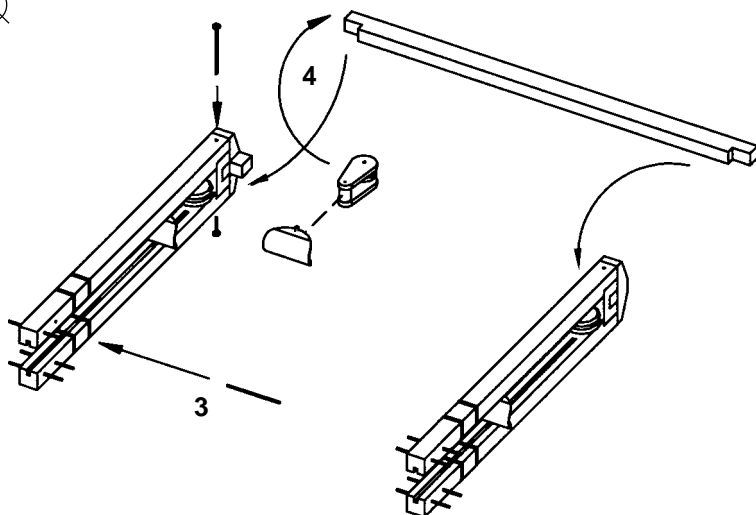

6. Assemble the sand-see-saw:
 Insert the axle of the see-saw into the stand posts, hold in position using battens and hammer the foundation irons into the stand posts.

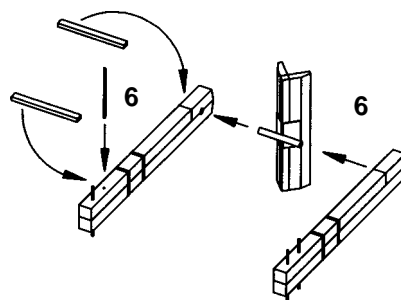

7. Place the sand-see-saw into the foundation holes and support in position with battens (**direction of rocking at right angles to transport rail**).

8. Screw the distance battens with brackets onto the stand posts of the see-saw according to **detail B**.

Detail B

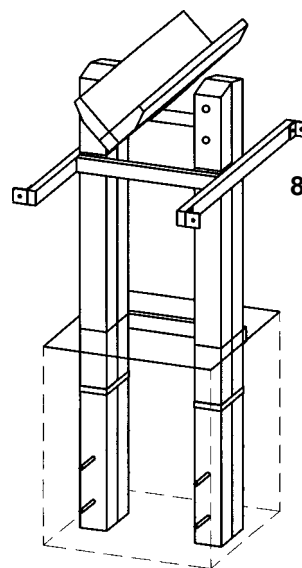
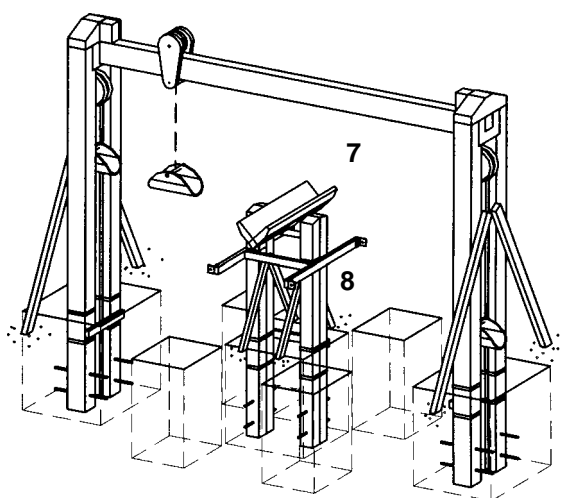

9. Join the stand posts of the **sand-sieves** with distance battens, hammer in the foundation irons into the stand posts and place into the foundation holes. Connect the sets of distance battens according to the marks, align and support in position using battens.

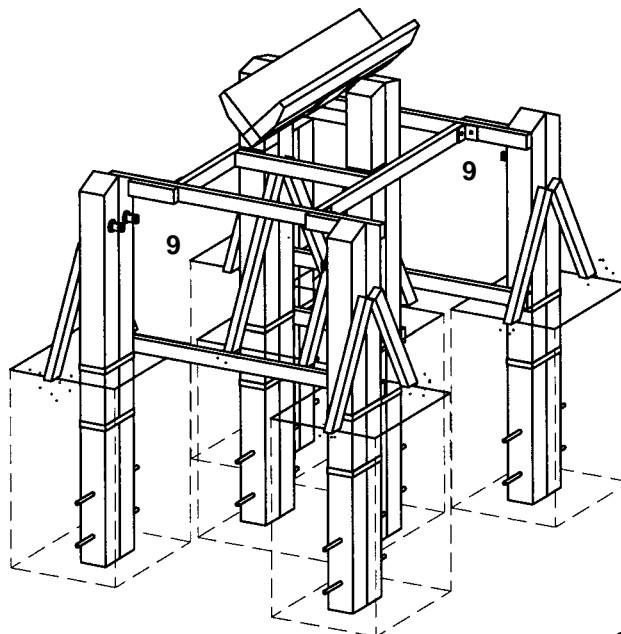
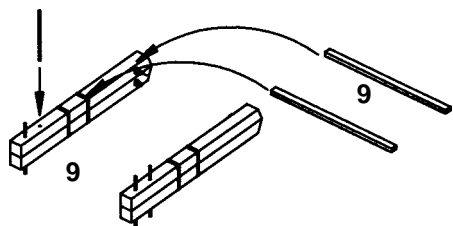

10. Fill the foundation holes with concrete B 25 (earth damp), largest grain size 16 mm and tamp. Round the edges of the foundations and cover with ground material.

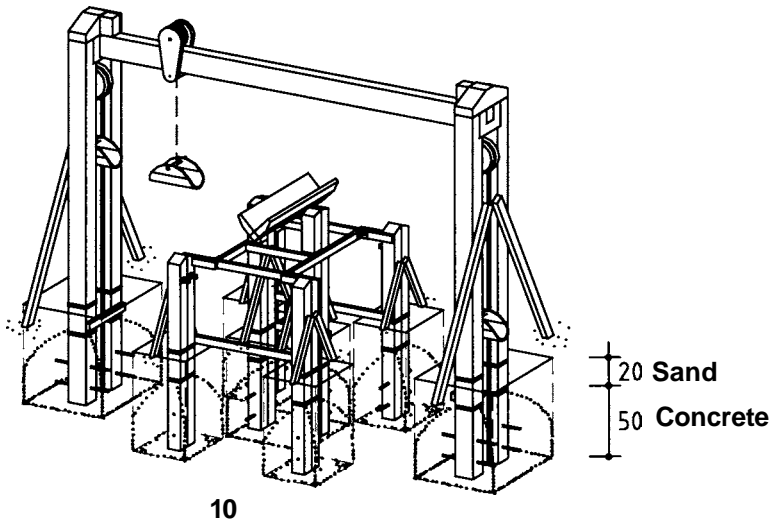

11. Install the sand sieves according to **detail C**.

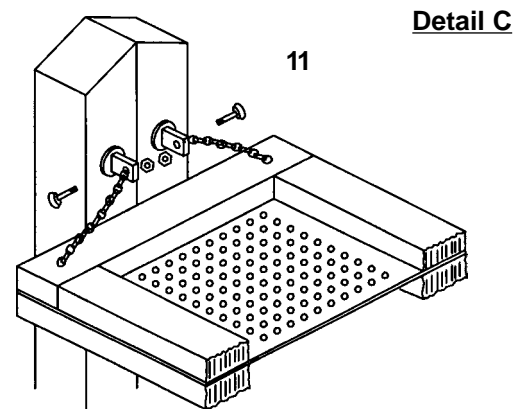

12. Repair minor damages caused during assembly or transportation.

13. Please ensure that all assembly aids, e. g. excess bolts, assembly instructions, distance battens or tape are removed entirely from the play equipment and the playground after work is finished.

Please note that after about 6 weeks all screws and bolts need to be checked and, if necessary, retightened.

